

# LIBRARIES CULTIVATE



# LIFELONG LEARNING



2018 KLA/KASL JOINT CONFERENCE • GALT HOUSE HOTEL • SEPTEMBER 19-22, 2018

## *Featuring*



**Trevor Claiborn & Ashley Smith,  
Co-Founders of Black Soil**



**Loida Garcia-Febo,  
ALA President**



**Tracy Maleeff, Cyber  
Analyst, GSK Security  
Operations Center**



**Sarah Hare, Scholarly  
Communication  
Librarian**

**Silas House,  
New York  
Times  
bestselling  
author**



**Bethany  
Barton, artist,  
author,  
illustrator**

## FEATURED SPEAKERS

**Silas House** is the New York Times bestselling author of six novels, including his most recent, Southernmost. His work frequently appears in The New York Times and Salon and he has been published in Garden and Gun, Oxford American, Newsday, Sojourners, and many other publications. He is a former commentator for NPR's "All Things Considered." He is a native of Southeastern Kentucky. **Mr. House is speaking at the Thursday Awards Luncheon (12:00-2:00pm) and signing books in the Exhibit Hall immediately after.**



**bethany bARTon** is an artist, author, and illustrator, based in Los Angeles. She is the author/illustrator of numerous children's books including *This Monster Needs a Haircut*, and *This Monster Cannot Wait*, both published by Dial/Penguin. Her 2016 book *I'm Trying to Love Spiders* was published by Penguin Random House, and has gone on to win numerous awards, including Children's Choice Awards 2016 Book of the Year. The follow up book *Give Bees A Chance* just hit book stores this spring. **Bethany is speaking at the Friday KBA Luncheon and signing books immediately after as well as presenting on Saturday (10:00-10:50am).**

**Loida Garcia-Febo** is an international library consultant, researcher and expert on topics such as human rights, advocacy and services to multicultural populations and President of the American Library Association. She has served communities as academic, public, school, and special librarian in Puerto Rico and Queens. **Ms. Garcia-Febo is presenting a General Session on Thursday morning (10:00-10:50am).**



Known fondly and widely as "Farmer Brown tha MC," **Trevor Claiborn** has led hundreds of children, youth, and adults in presentations on food production, sustainable systems, and outreach regarding agricultural occupations, using culturally relevant education via hip hop and statistics. He holds degrees from Bluegrass Community & Technical College, in Environmental Systems, and Kentucky State University, in Agriculture, Food, and Environment.



**Ashley C. Smith** graduated from the University of Kentucky in 2008 with a Bachelor of Arts in Sociology. Smith currently serves as Director of Education and Governmental Affairs for Fayette Alliance. Smith is an Ethical Redevelopment Salon member under the leadership of Theaster Gates, Secretary for Kentucky State University's Extension and Research Advisory Council. **Trevor & Ashley are presenting on Thursday afternoon (3:00-3:50pm).**



As Scholarly Communication Librarian, **Sarah Hare** collaborates with subject librarians, the IU Press, and Library Technologies to educate and advise the campus community on open access and related issues. She also serves as liaison to IU's Office of Scholarly Publishing. Sarah's research focuses on scholarly communication outreach to undergraduate students and Open Educational Resources (OER). Sarah also teaches an eight-week Library Juice Academy course, "Introduction to Open Educational Resources," for library and information professionals worldwide. **Sarah is presenting on Friday morning (11:00-11:50am).**

**Tracy Z. Maleeff** is a Cyber Analyst in the Security Operations Center for global pharmaceutical company GSK. She holds a Master of Library and Information Science degree from the University of Pittsburgh. She has 15+ years' experience as a law firm librarian and worked as an independent consultant who specialized in social media, research, and Information Security awareness training. She actively tweets as [@InfoSecSherpa](https://twitter.com/InfoSecSherpa) and has a daily Nuzzel newsletter, <http://nuzzel.com/InfoSecSherpa>. **Tracy is presenting Friday morning (10:00-10:50am).**



# GENERAL INFORMATION

## Registration Information & Fees

	<u>Members*</u>	<u>Non-Members*</u>
Full Conference	\$145	\$215
Student Full Conference	\$15	\$30
Retiree Full Conference	\$30	\$50
Thursday ONLY	\$120	\$180
Friday ONLY	\$120	\$180
Saturday ONLY	\$120	\$180

**Registration fees include** access to the exhibit hall and all presentations, EXCEPT plated luncheons. Tickets to the Thursday Awards Lunch and Friday KBA Luncheon must be purchased separately and in advance. Registration packets may be picked up at the Conference Registration Desk, located in the Galt House Rivue Tower. After Monday, September 17<sup>th</sup>, please register on-site at the Conference Registration Desk.

### Conference Registration Desk Hours

Thursday, Sept. 20	7:00 AM - 5:00 PM
Friday, Sept. 21	7:30 AM - 5:00 PM
Saturday, Sept. 22	7:00 AM - 11:30 AM

**For security reasons, you must visibly wear your 2018 Conference nametag to ALL EVENTS, including presentations and the exhibit hall.**

## Presentation Locations

You can find the room name for each presentation in the schedule listing in **red** under the speaker(s) name(s). *Rooms with tree names are on the third (3<sup>rd</sup>) floor; rooms with flower names are on the second (2<sup>nd</sup>) floor.*

## Social/Ticketed Events

Tickets for the Thursday Awards Luncheon and the Friday KBA Luncheon must be purchased in advance. Anyone can attend the Thursday Scavenger Hunt at no charge- just show up to the Conference Registration Desk between 6:00pm and 7:00pm to pick up your set of clues!

### **THURSDAY, 12:00 – 2:00pm KLA Awards Luncheon Featuring Silas House**

Join us as we honor our colleagues for outstanding contributions to the profession. Our keynote speaker will be noted Kentucky author, Silas House, whose latest novel, *Southernmost*, was published in June.

### **THURSDAY, 6:00 – 10:00pm KLA Scavenger Hunt!**

Meet at the registration desk between 6 pm and 7 pm to obtain your scavenger hunt clue list. Participate on your own or form a team. Use clues to find and make note of books hidden in local establishments within walking distance of the Galt House. **Turn in your completed form by 10pm to be entered to win fabulous prizes!** Prize drawing will be held promptly afterwards. *Sponsored by the KLA Member Services Committee*

### **FRIDAY, 12:00 – 2:00pm KBA Luncheon Featuring Bethany Barton**

Our keynote speaker will be Bethany Barton, the KBA award-winning author of *I'm Trying to Love Spiders*.

## Conference Venue

The Galt House Hotel & Suites is the site of the 2018 KLA/KASL Joint Conference. Located on the corner of Fourth and Main, the Galt House is the city's *only* riverfront hotel. You will be steps away from Louisville's downtown attractions such as the YUM Center, 4th Street Live, Waterfront Park, the Louisville Slugger Museum, Louisville Glassworks and the Muhammad Ali Center... and many of Louisville's most famous restaurants and bars. **The Galt House is a non-smoking facility. Restaurants and bars in Louisville are also non-smoking.**

***See pages 25-26 for 2<sup>nd</sup> and 3<sup>rd</sup> Floor maps of the Galt House Rivue Tower!***



### **Parking**

Park at the hotel starts at \$15.00 per day (self-park) or \$28.00 per day (valet) for KLA attendees staying at the Galt House. The fee will be charged to your room for overnight guests. All other attendees will pay upon departure. *KLA cannot validate parking tickets.* **Non-guest rates may vary.** There are alternative parking lots in the area at lower rates.

### **Mobile App**

**[Find a link to the mobile app here.](#)** The mobile app provides greater flexibility for last minute changes and updates and lessens KLA's environmental impact. If you have any difficulties, please come to the Conference Registration desk for assistance.

### **Membership Meeting**

The Kentucky Library Association holds its annual meeting of the general membership at the KLA Business Meeting on Thursday, September 20, at 4:00 PM in conjunction with this Conference.

### **Exhibit Hall**

The Exhibit Hall opens on Thursday at 2:00 PM. Please show your support by visiting each of the exhibitors. For security reasons, **you must visibly wear your 2018 Conference nametag to enter the Exhibit Hall.**

#### Exhibit Hall Hours

Thursday, Sept. 20	2:00 - 5:00 PM
Friday, Sept. 21	8:00 AM - 5:00 PM
Saturday, Sept. 22	7:00 AM - 12:00 PM

### **Statement of Appropriate Conduct**

The Kentucky Library Association holds professional conferences and meetings to enable its members to receive continuing education, build professional networks, and discover new products and services for professional use. To provide all participants the opportunity to benefit from the event, the Kentucky Library Association is committed to providing a safe and harassment-free environment for everyone, regardless of gender, sexual orientation, gender identity, gender expression, disability, physical appearance, ethnicity, religion or other group identity. Violators may be asked to leave the conference premises.

## **Wednesday, September 19, 2018**

**5:00 – 6:00pm** KLA Board Meeting  
**Holly**

## **Thursday, September 20, 2018**

**8:00 – 8:50am**

### **Cultivating the Internal Learning Environment: Strategies for Knowledge Management in Library Organizations**

*Jennifer Bartlett, Interim Associate Dean, University of Kentucky Libraries*

#### **Willow**

As librarians, we're experienced at providing and interpreting knowledge and information to our external patrons and clients. But how well do we manage our own internal institutional information? If someone leaves, does their knowledge go with them? Are our procedures well-documented and frequently updated? Do we offer regular training for staff? In this session we will explore strategies, tools, and best practices to build and maintain an active institutional learning environment, including a discussion of explicit and tacit knowledge, effective on-boarding of staff, communities of practice, and succession planning. Participants will be asked to share their own current KM practices and issues and will be provided with a KM Toolkit to use in their own institutions.

### **Saving Yesterday for Tomorrow: Community Outreach**

*Nancy Richey, Associate Professor/Visual Resources Librarian, WKU*

*Joe Shankweiler, Assistant Professor, Special Collections Catalog Librarian, WKU*

#### **Dogwood**

Lifelong learning is defined as a purposeful learning activity undertaken on an ongoing basis with the aim of improving knowledge, skills, and competence. Libraries and lifelong learning are symbiotic partners and are one of the best environments for this knowledge exchange to take place. One of the ways our library addresses these emerging needs is by offering beginning preservation and genealogy classes to the community to engage with lifelong learners. Our presentation will showcase these outreach efforts with lifelong learners and highlight what has worked best for us. The presentation will then discuss how these classes foster social responsibility and expand the visibility, access, and influence of all libraries.

### **Fostering Community, Developing Connections to the Foster and Adoptive Families in Your Community**

*Michael Richter, Director, Bath County Memorial Library*

#### **Jasmine**

More than 9,000 Kentucky children are in foster care. Most of those children will spend nearly two years in the state foster care system. Many of the children who are committed to care will need additional academic and social support. A lucky few might find some at the library. Foster children and the families they live in have special needs and unique concerns. Learn some things that your library can do to help foster your community, by helping foster families. Ask yourself: Do your circulation policies and procedures stop foster kids and foster families from using the library? What services and support can your library provide to patrons and students who are in the foster care system? What misconceptions about foster care do you have? Adopt some of the tools and skills we created to better serve these families, and foster communities at the same time.

### **Your Reservation Is Confirmed: Young Library's Transition to Online Reservations for Study Spaces**

*James Britt, Second Shift Circulation Supervisor, University of Kentucky*

#### **Lily**

In Fall 2017, Young Library instituted a new online reservation system for our group study rooms. Previously, group study rooms were available first-come, first-served, and restaurant-style buzzers were used to notify patrons on a wait-list. Now patrons are able to make reservations up to a week in advance, choose what room they like, and have certainty of when they will have access to a study space. This presentation will discuss the challenges in such a transition, overall performance of the system, and patron feedback.

### **Power to the Professional: Fostering a Research Mind Shift in Adults**

*Kayla L. Meadows, Research Services (Resources) Assistant, Hogan Lovells US LLP*

#### **Holly**

Despite often being highly-educated individuals who push the envelope in their fields, professional adults are also difficult patrons. They are some of the first to reject changes in established avenues of information. The shift in professional environments from print to digital libraries can be especially challenging. How can information professionals make this transition easier? How do they foster a culture of progress for an audience with roots in "Reference Desk" research? In order to acclimate to a changing information landscape, these professionals need to feel as comfortable with a search engine as a reference book. Come learn how we can offer them that power—and foster lifelong learning in the process.

### **THURSDAY, 9:00 – 9:50am**

#### **All Things Wacky in the Library**

*Brandy Tyler, Children's Outreach and Programming Specialist, Bullitt County Public Library*

*Angel Holbert, Children Service's Librarian, Bullitt County Public Library*

#### **Willow**

STEAM...We felt you roll your eyes. If we are over this term, so are children and their parents. It is reiterated all day at school, it is expensive, and it requires adult supervision. So how do we keep STEAM programs from becoming a fad? We drop the term—keep the word STEAM and other words associated with it behind the curtain—and let the kids just enjoy Oz. At Bullitt County Public Library, we have accomplished this through programs such as Makerspace, Peeps Catapults, Slime Labs, and Wacky Weather! Join us for a low-key, more hands-on session experience, and feel free to ask questions about the programs we have designed to covertly engage students in STEAM activities, teaching kids and teens integral skills without them ever realizing they are actually learning.

## **Teaching with Students, Not to Them: Lessons Learned from Student-Faculty Partnership**

*Amanda Peach, Reference and Instruction Librarian, Berea College*

*Ashley Ferrell, Technology Help Desk Student Supervisor, Berea College*

### **Dogwood**

The Instruction Librarians at Berea College have invested considerable time trying to improve our efficacy as teachers. In spite of our good intentions, however, there are times when we look out into the classroom and are shocked by the number of blank stares we encounter. After asking ourselves some hard questions about why this disconnect persists, we decided to participate in a Student-Faculty Partnership Program. The program pairs an undergraduate student with a faculty librarian who then mentors the librarian weekly, observing them in the classroom and then providing them with constructive criticism/feedback afterwards regarding the effectiveness, organization, and clarity of their instruction, based on their unique perspective as a student. This session will share what we learned through the process, changes we implemented, and ideas for scaling at your institution.

## **Researching at KDLA**

*Jennifer Patterson, Archival Services Branch Manager, KY Dept. for Libraries and Archives*

*Walter Bowman, Research Room Supervisor, KDLA*

### **Lily**

The Kentucky Department for Libraries and Archives maintains a vast number of Kentucky's permanent records. These include court cases, vital statistics, and local records (deeds, marriages, wills, taxes, etc.). Our holdings are an important source for genealogical research within Kentucky, and we would like to provide you with an overview of our collection and services in order to help you better assist your customers.

## **"I Didn't Mean Anything by It": How Microaggressions Are Perceived**

*Chris Robinson-Nkongola, Assistant Professor, Glasgow Regional Librarian, Western Kentucky University Libraries*

### **Holly**

At the time of researching for this presentation, covert racism was thought to be a thing the past. The type of racism that was openly sanctioned by society. For example, explicit racism or "the old fashion racism" would be segregation, lynching, and Jim Crow. However, the aversive racism, also called microaggressions, are daily subtle attitudes and behaviors that people of color experience as the result of their race. Psychologists, educators, and other clinicians have discovered how microaggressions affect the person of color psychologically and physically. This presentation will provide definitions and classifications as well as examples of microaggressions. Since microaggressions are so subtle, this presentation will give the person of color prescriptions on dealing with them. Additionally, it will provide helpful advice to members of the dominant culture in regard to microaggressions. ***Sponsored by the Library Management Skills Roundtable***

## **Improving Library Interfaces: How to Decide What Matters to Our Patrons**

*Cristina Tofan, Coordinator of Technology & Data Services, ECU Libraries*

*Todd King, Systems Administrator, ECU Libraries*

### **Jasmine**

In the past few years many libraries implemented single search interfaces. But how well do these systems work for our diverse categories of users? Are they meeting the expectations of relevant search results and ease of use that our patrons are accustomed to from using Google? In this session we will discuss how we made changes to the search interface based on users' needs and preferences. Instead of just guessing users' problems, we based our decisions on real user data. We will also present the multi-angle approach we took to assess and customize the system to try and simplify access to our resources, reduce confusion, and improve our users' experience.

## **THURSDAY, 10:00 – 10:50am**

### **General Session**

#### **Better Together: Building Stronger Communities**

*Loida Garcia-Febo, ALA President, President, Information New Wave*

#### **Willow**

Libraries of all types are bastions of democracy, access, intellectual freedom, diversity and the public good. Our profession's core values propel us to serve patrons, students, and faculty in a wide variety of ways. We must continue promoting the value of libraries to enrich our communities. Libraries help job seekers, entrepreneurs, people with health conditions, seniors, and those with different linguistic backgrounds and abilities. Libraries play a central role in helping people and communities. Loida Garcia-Febo's keynote will bring together concepts of libraries of all types as pillars of education and at the intersection of human rights, universal access to information, serving diverse and multiethnic populations, and making your library a welcoming place to all members of the community. This presentation will include examples of programs from libraries in the USA.

**Loida Garcia-Febo** is an international library consultant, researcher and expert on topics such as human rights, advocacy and services to multicultural populations. President-Elect of the American Library Association. She has served communities as academic, public, school, and special librarian in Puerto Rico and Queens. Loida is President of Information New Wave an international NGO seeking to enhance the education of ethnically diverse communities. She has taught in 21 countries and has advocated on behalf of libraries at the United Nations, US Congress, NYC City Hall, NY State Senate and on streets and sidewalks of New York.

## **THURSDAY, 11:00 – 11:50am**

### **Makerspace Mentality: Making It Work in Any Space**

*Ashley Fowlkes, Branch Manager, Warren County Public Library*

#### **Dogwood**

Public libraries with limited budgets may not be completely confident providing a makerspace for their clientele, but with a few key components, libraries of any size can adapt a makerspace mentality and make it work.

### **Introducing Bullet Journaling to Your Community**

*Julie Howe, Director of e-Learning and Health Sciences Librarian, SCC Learning Commons*

#### **Jasmine**

One of Kentucky's Workforce Challenges set forth in the July 2015 publication is employees arriving in the workplace without soft skills. While some of these soft skills are taught in the classroom, this also gives the library the opportunity to actively demonstrate value by teaching soft skills in a workshop setting. Some of the soft skills that are necessary for productivity and success in the academic session include understanding how to plan ahead, and prioritizing and organizing tasks. This session focuses on teaching students, as well as faculty and staff, the bullet journaling method as a way to plan, organize, prioritize, and keep track of tasks. Ideas for workshops/programming on this topic will be provided for various time frames. *The first 25 participants will receive supplies to start their first bullet journal in the session. **Sponsored by the Community & Technical College Roundtable***

### **Tips and Tricks in EBSCO Databases**

*Lisa Jones, EBSCO Training Specialist, EBSCO*

#### **Holly**

KYVL subscribes to some fantastic EBSCO databases! Come and learn to get the most out of the databases, including advanced search using field codes, setting up journal and search alerts (and why they might be useful), and some of the "hidden gems" that are available to you and your patrons.

## **Using DNA for Genetic Genealogy**

*Caleb May, Director, Henderson County Public Library*

### **Lily**

As DNA testing companies such as 23 and Me, Ancestry DNA, Family Tree DNA, etc., become more and more popular, library patrons are increasingly interested in this process and how it can be useful to help solve genealogy questions. This presentation gives an overview of the different types of DNA for genealogy tests, how to interpret the results, and how the presenter used DNA evidence to solve a 100-year mystery in his family tree.

## **Aligning the Mis-aligned: Tying Assessment to the ACRL Standards for Libraries in Higher Education**

*Andrew Adler, Director of Library Services, Georgetown College*

### **Willow**

Having problems with assessment? Don't know what to do? Guess what: neither do I. Who does? But why don't we get together and have a workshop based around ACRL's Standards for Libraries in Higher Education where we look to see how what we are currently doing aligns with what they think we should be doing. Based on what I learned from the New Library Directors' Workshop, I think we just might be able to help each other out.

## **So You Wanna Be a Public Library Trustee ...**

*Chris Bischoff, Region North Consultant, Ky. Dept. for Libraries & Archives*

### **Walnut**

Trustees serve on a public library's governing board and make a powerful contribution to their community, while developing new skills, gaining valuable experience, and having fun! Find out if becoming a Public Library Trustee is right for you! For newly appointed trustees, this program can serve as your KDLA Trustee Orientation.

## **THURSDAY, 12:00 – 2:00pm**

### **KLA Awards Luncheon Featuring Silas House**

#### **Waterford Room, 25<sup>th</sup> Floor**

Join us as we honor our colleagues for outstanding contributions to the profession. Our keynote speaker will be noted Kentucky author Silas House, whose latest novel, *Southernmost*, was published in June. *Be sure to purchase a ticket on the registration form.*

**Silas House** is the nationally bestselling author of five novels--*Clay's Quilt*, 2001; *A Parchment of Leaves*, 2003; *The Coal Tattoo*, 2005; *Eli the Good*, 2009; and *Same Sun Here* (co-authored with Neela Vaswani) 2012--as well as a book of creative nonfiction--*Something's Rising*, co-authored with Jason Howard, 2009; and three plays: *The Hurting Part* (2005), *This Is My Heart for You* (2012), and *In These Fields*, with Sam Gleaves, 2016.

His work frequently appears in *The New York Times* and *Salon*. He is a former commentator for NPR's "All Things Considered." His writing has appeared in *Oxford American*, *Narrative*, *Blackbird*, *Newsday*, as well as in anthologies such as *Best Food Writing, 2015* and *New Stories From the South, The Year's Best: 2004*. House serves on the fiction faculty at the Spalding MFA in Creative Writing and as the NEH Chair at Berea College.

He is a member of the Fellowship of Southern Writers, the recipient of three honorary doctorates, and is the winner of the Nautilus Award, an EB White Award, the Appalachian Book of the Year, the Jesse Stuart Award, the Lee Smith Award, and many other honors.

## **THURSDAY, 2:00 – 3:00pm**

### **Exhibit Hall Opens**

#### **Archibald (3<sup>rd</sup> Floor)**

*Dedicated time to visit our vendors!*



## THURSDAY, 2:00 – 2:30pm

### Book Signing in the Exhibit Hall

*Silas House, Author*

### Archibald (3<sup>rd</sup> Floor)

**Silas House** is the nationally bestselling author of five novels--*Clay's Quilt*, 2001; *A Parchment of Leaves*, 2003; *The Coal Tattoo*, 2005; *Eli the Good*, 2009; and *Same Sun Here* (co-authored with Neela Vaswani) 2012--as well as a book of creative nonfiction--*Something's Rising*, co-authored with Jason Howard, 2009; and three plays: *The Hurting Part* (2005), *This Is My Heart for You* (2012), and *In These Fields*, with Sam Gleaves, 2016.

His work frequently appears in *The New York Times* and *Salon*. He is a former commentator for NPR's "All Things Considered". His writing has appeared in *Oxford American*, *Narrative*, *Blackbird*, *Newsday*, as well as in anthologies such as *Best Food Writing, 2015* and *New Stories From the South, The Year's Best: 2004*. House serves on the fiction faculty at the Spalding MFA in Creative Writing and as the NEH Chair at Berea College.

He is a member of the Fellowship of Southern Writers, the recipient of three honorary doctorates, and is the winner of the Nautilus Award, an EB White Award, the Appalachian Book of the Year, the Jesse Stuart Award, the Lee Smith Award, and many other honors.

## THURSDAY, 3:00 – 3:50pm

### Black Soil: Our Better Nature

*Trevor Claiborn, Co-Founder, Black Soil*

*Ashley C. Smith, Co-Founder, Black Soil*

### Willow

Black Soil: Our Better Nature is an agritourism project missioned to connect black Kentuckians with their heritage and legacy in agriculture. Our methodology encourages participants to practice the art of being lifelong learners sustained by skills, practices, and techniques found in agriculture. We will provide an overview focused on the creation of the project, highlight the farmer network that grew from one farm family to twelve within six months, and profile the importance of embracing the benefit of being a student for life. The presentation centers around how the combination of interpersonal relationships, event-based education, and providing opportunities for leadership is transforming the lives of black Central Kentuckians. ***Sponsored by the Kentucky Public Library Association***

Known fondly and widely as "Farmer Brown tha MC," **Trevor Claiborn** has led hundreds of children, youth, and adults in presentations on food production, sustainable systems, and outreach regarding agricultural occupations, using culturally relevant education via hip hop and statistics. He holds degrees from Bluegrass Community & Technical College, in Environmental Systems, and Kentucky State University, in Agriculture, Food, and Environment, where he also works as a Farm Technician and 4-H Extension Assistant in the Land Grant Program. In his spare time, he administers the original programs Fresh Op, an urban gardening workshop, and Basics for Young Bosses, an after-school production camp that produces a collection of original children's books.

**Ashley C. Smith** graduated from the University of Kentucky in 2008 with a Bachelor of Arts in Sociology. Smith currently serves as Director of Education and Governmental Affairs for Fayette Alliance. Previously, she has worked for such brands as KentuckyOne Health, Bluegrass Hospitality Group, Community Ventures, NetGain Technologies, Smiley Pete Publishing, and The Lyric Theatre & Cultural Arts Center. Smith is an Ethical Redevelopment Salon member under the leadership of Theaster Gates, Secretary for Kentucky State University's Extension and Research Advisory Council, and 2016 Scholarship Chair for the Bluegrass Chapter of the Association of Fundraising Professionals.

## **Archives After Dark: Developing Wonder and Sparking Creativity Through Engagement with Historical Artifacts**

*Deborah Whalen, Special Collections Librarian, Eastern Kentucky University*

*Trenia Napier, Noel Studio Associate Director, Programs and Outreach, Eastern Kentucky University*

*Jackie Couture, Special Collections & Archives Team Leader, Eastern Kentucky University*

### **Lily**

"It was one of the most amazing experiences of my entire life. I could not have been more lucky to be surrounded by so many talented and creative people, and the sense of history and purpose was wonderful." Imagine eleven Eastern Kentucky University students with the opportunity to spend a night in the library to develop and polish their own creative work based on historical items housed in Special Collections and Archives. Combine that with the fabulous space and student consultants of the Noel Studio for Academic Creativity, and you've got Archives After Dark, a celebration of archival collections and the creative process of telling (through any medium) the stories inspired by archives items. Hear how we pulled this learning opportunity together, from event planning and item selection to the publication and presentation of the student work at the university.

## **The Schoolyard Never Ends: The Continued Presence of Workplace Bullying and How to Manage It**

*Jack Montgomery, Professor; Coordinator of Acquisitions and Collection Services, Western Kentucky University Libraries*

*John Gottfried, Associate Professor; Coordinator of Reference Services/Business Librarian, Western Kentucky University Libraries*

### **Jasmine**

According to a 2005 American Psychological Association publication, "Workplace bullying is a persistent pattern of mistreatment from others in the workplace that causes either physical or emotional harm." Workplace bullying is responsible for a host of negative impacts on the workplace environment, including employee illness and absenteeism, loss of work productiveness, and employee retention to name a few. Often, targets of workplace bullying do not even recognize that they are being bullied, mobbed, or harassed as a result of activities like onboarding, malicious gossip, and even online harassment. This presentation will teach attendees to recognize workplace bullying, intervention techniques, teaching co-worker responsiveness, and target empowerment, with the objective of helping those in management positions to effectively respond to this all too common and negative workplace experience. ***Sponsored by the Library Management Skills Roundtable***

## **Escape from Boredom: Using Breakout EDU to Revamp Instruction**

*Rodney Watkins, Instruction & Learning Technology Librarian, Morehead State University, Camden-Carroll Library*

### **Dogwood**

Varying student experiences. Unpredictable levels of faculty engagement. Ever-changing administrative expectations. These are just some of the things librarians must face throughout their careers. But for the instruction librarians at Camden-Carroll Library, it was all three at once. Due to the dismantling of the campus QEP, the introduction of a new GenEd program, and the upheaval of staff reorganization, the instruction department needed to find a way to revamp their first-year offerings. And fast. Enter BreakOut EDU: the "escape room" game with an educational purpose. With choices of a physical game or digital version, with paid or free lesson options, which are either pre-packaged or fully-customizable, BreakOut EDU is a way to introduce library orientation and/or critical thinking lessons in an interactive, group activity format. This session will focus on an introduction to the game, how the librarians implemented it, and the outcome of that change.

## **KYVL Q&A**

*Ilona Burdette, Director, Kentucky Virtual Library*

### **Holly**

Brief updates from the director, followed by Q&A on topics of current interest, such as databases, courier, Kentucky Digital Library, membership, funding, strategic plan, website, and more.

## **Creative Burnout: Practical Tips for Keeping Yourself from Burning to a Crisp**

*Jennifer Joe, Owensboro Campus Librarian, Western Kentucky University*

### **Walnut**

Librarians can be a passionate group of people, and highly dedicated to their jobs. This, as in any profession, can lead people to push themselves too far, and they will experience burnout. Because of the creative nature of librarianship, including publishing, presenting, program planning, and marketing service campaigns, creative burnout can be especially problematic. This presentation will give an overview of the warning signs of creative burnout, the reasons behind creative burnout, and ways that librarians can cope with creative burnout, including job crafting (organizing one's roles and responsibilities in such a way to minimize stress and burnout) and preparing and maintaining one's working space to facilitate creativity.

### **THURSDAY, 4:00 – 4:50pm**

#### **KLA Business Meeting**

##### **Willow**

### **THURSDAY, 5:00 – 5:50pm**

#### **Academic Library Section Business Meeting**

##### **Dogwood**

#### **Special Library Section Business Meeting** *(After conclusion of ALS meeting)*

##### **Dogwood**

#### **Kentucky Public Library Association Business Meeting**

##### **Willow**

### **THURSDAY, 6:00 – 6:45pm Board & Roundtable Meetings**

KPLA Board Meeting **Willow**

Genealogy and Local History Roundtable **Walnut**

Government Documents Roundtable **Lily**

Library Management Skills Roundtable **Holly**

Community & Technical College Roundtable **Dogwood**

### **THURSDAY, 6:00 – 10:00pm KLA Scavenger Hunt!**

Meet at the registration desk between 6 pm and 7 pm to obtain your scavenger hunt clue list. You can participate on your own or form your own team. Use your clues to find and make note of books hidden in bars and other establishments located within walking distance of the Galt House. **Deliver your completed form at the final destination to be entered to win fabulous prizes!** Take your time and enjoy the city, grab dinner and meet new friends! Just be sure to finish and turn in your form by 10 pm. Prize drawing will be held promptly afterwards. **While there is no fee for this activity, be sure to mark your interest on the registration form so we may plan for the appropriate number of participants.** *Sponsored by the KLA Member Services Committee*

## Friday, September 21, 2018

**8:00 – 8:50am**

### **Friends Programs, Libraries, and the New Tax Act**

*Bryan Carson, Director of the Library, Missouri Valley College*

#### **Willow**

The new Tax Act passed at the end of 2017 will cause significant changes to the ways that non-profit groups operate. This includes both not-for-profit and governmental-sponsored libraries, as well as Friends groups. Both public and private schools will also be affected by these changes. From charitable contributions to state and local tax deductibility, the new Act has changed the legal landscape. This program will explain the changes in the Tax Act in easy to understand (non-legal) English and will provide audience members with strategies to work with the new law.

### **Reaching out Through Outreach**

*Gayle Ryan, Library Specialist, Bullitt County Public Library*

*LaDonna Thompson, Library Specialist, Bullitt County Public Library*

*Mike Harlamert, Library Specialist, Bullitt County Public Library*

#### **Dogwood**

Bullitt County Public Library provides outreach and programming for populations that may be underserved by public libraries: seniors, adults in day facilities, adults with developmental disabilities, the home bound, and teens at residential homes. The presenters will engage the participants with ideas for outreach, challenges that have been experienced, lessons well learned, and areas of success. The presentation will consist of lecture, open discussion, examples of interactive tools used during the outreach, and/or photographic displays of actual outreach programs.

### **What's Happening in the Regional Depository Library**

*Amy Laub-Carroll, Federal Regional Depository Librarian, University of Kentucky*

#### **Lily**

This will be an overview of what a Regional Depository Library is, the current projects we are working on, and government information that is available to everyone free of charge. A portion of this presentation will focus on UK Libraries' three ASERL (Association of Southeastern Research Libraries) Centers of Excellence collections, which include the WPA (Works Progress Administration), the Appalachian Regional Commission, and the Smithsonian Institution.

### **Using a Professional Networking Group to Highlight Community Resources, Build Partnerships and Drive Business to Your Library**

*Natalie Ruppert, Manager, Workforce Development, Kenton County Public Library*

#### **Jasmine**

Create a professional networking group at your library to highlight community resources, build partnerships and drive business to your library. Learn about ways to offer great programming at low cost by partnering with local business leaders. Help people grow their skills to stay competitive in the job market and make connections with those in hiring positions.

### **The Digital Toolbox: Lending Mobile Hotspots and Laptops**

*Aaron Williams, Adult & Digital Services Librarian, McCracken County Public Library*

#### **Holly**

In this presentation, I'll provide an overview of the McCracken County Public Library's mobile hotspot and laptop lending program known as the Digital Toolbox Initiative. Attendees will learn how we funded and compiled our digital toolboxes, including how we ordered the mobile hotspots from library and nonprofit vendor, TechSoup. They will be given an initial estimate of the cost to start a program at their library. Attendees will also learn the lending policies we put in place at McCracken County Public Library to protect the library's investment as well as patron privacy. The presentation will also go over staff procedures for handling the check in and check out of hotspots and laptops. Finally, the presentation will discuss data collection and surveying as a means of advocating for additional program funding.



**FRIDAY, 9:00 – 9:50am**

**What Happens When Public Libraries Partner with School Libraries (And HOW Do You Do It?)**

*Andrea Lawler, Librarian/Media Specialist, Taylor County High School*

*Kimberly Burton, Children & Youth Librarian, Taylor County Public Library*

*Tammy Snyder, Library Director, Taylor County Public Library*

**Dogwood**

During this session, presenters intend to discuss wide-ranging aspects of their experience partnering public and school library systems. Topics will include reasons for partnerships, approaches to partnering, bookmobile and outreach services, programming, continued relationship growth, challenges of partnerships, advantages of partnerships, and a time for questions. Presenters will include public and school library staff.

**Lessons Learned Abroad: Access and Empowerment Through Universal Design**

*Ashley DeWitt, Faculty Lecturer, University of Kentucky School of Information Science*

*Jennifer Jeffers, Library Science Graduate Student, University of Kentucky*

**Willow**

People need access to information to be lifelong learners, but what may be accessible to some may not be accessible to all. In this session, participants will learn how libraries in the U.S. and abroad are using Universal Design, which emphasizes that “what is necessary for some can be good for all,” to empower patrons to be lifelong learners. The session will begin with a review of the foundational principles of Universal Design before outlining approaches observed when visiting a variety of libraries in the Netherlands during a graduate-level library science course. The session will then move into a deeper discussion of Universal Design as it relates to spaces, technology, policies, and instruction in libraries. While the needs of students using academic libraries who are refugees, immigrants, and/or have disabilities will guide the discussion, the presentation will conclude with a guided brainstorming session to help participants explore strategies for employing Universal Design to benefit the users in their own libraries.

**Perspectives in Intellectual Freedom**

*Mercedes MacLean, Teen Librarian, Scott County Public Library*

*Mary Landrum, Children’s Librarian, Lexington Public Library-Village Branch*

**Holly**

What does intellectual freedom mean today in our political climate? What new challenges are librarians and libraries facing in providing services to patrons? KPLA's Intellectual Freedom Committee will host this session and look in depth at intellectual freedom in Kentucky. Come join our discussion about how to strengthen your library, collection, and services against intellectual freedom challenges. **Hosted by the KPLA Intellectual Freedom Committee**

**Tech Planning & E-Rate**

*Lauren Abner, Technology Consultant, Kentucky Dept. for Libraries & Archives*

**Walnut**

Public libraries face growing demand for bandwidth to support videoconferencing, online learning, makerspace activities, and more for both patrons and staff. Getting better bandwidth—and having the networking equipment to use it effectively—requires careful planning for technology needs and the library budget. This presentation will discuss the revised tech plan template provided by the Kentucky Department for Libraries & Archives for libraries working toward Kentucky Public Library Standards, as well as seeking discounts on internet access & networking equipment through the E-rate program.

**Resource Sharing in Kentucky: Thoughts from the Field**

*Jennifer Bartlett, Interim Associate Dean, University of Kentucky Libraries*

**Lily**

Interested in interlibrary loan, distance learning, circulation, and access services in general? Join us for a panel discussion in which we’ll talk about topics such as ILLiad, Tipasa, RapidILL, resources for online learning and distance students, and more. Bring your questions and ideas! **Hosted by the Resource Sharing Roundtable**

## **The Appalachian Regional Heritage Stewardship Program: Collections Care Training in Kentucky**

*Dyani Feige, Director of Preservation Services, Conservation Center for Art & Historic Artifacts*

### **Jasmine**

The speaker will give an introduction to the NEH-funded Appalachian Regional Heritage Stewardship Program and give a perspective on the preservation and conservation challenges facing the region's collecting institutions. After the presentation, the speaker will lead a discussion strategizing with participants on what resources they feel are needed and collaborative approaches to meet those needs. Even though the program is nearing completion of its first round, there is still time for collections staff in Kentucky to provide input on and potentially shape the offerings of the program. What is missing in the region? As Kentucky librarians, how could a program like this help you and your institution? What strengths do you and your colleagues have to share, that we might be able to incorporate into the program's future offerings? The goal of the session is to capitalize existing networks and partnerships for greater stewardship of collections and is intended for collections stewards, board members, and others charged with collections care.

## **FRIDAY, 10:00 – 10:50am**

### **Information Security Basics for Librarians and Researchers**

*Tracy Maleeff, Cyber Analyst, GSK Security Operations Center*

### **Willow**

Hack. Breach. Ransomware. These words appear in the news headlines daily, causing much fear and anxiety. Take a deep breath and listen to this non-technical talk from a librarian turned cybersecurity professional. Get an understanding of Information Security vocabulary and best practices for the protection of your personal and library data. Learn what resources are available for the purposes of news monitoring, collection development, or training. You will come away from this session empowered with knowledge of how to create some defenses and deal with Information Security matters without fear, uncertainty, or doubt. ***Sponsored by the Special Library Section***

**Tracy Z. Maleeff** is a Cyber Analyst in a Security Operations Center for a global company. Tracy holds a Master of Library & Information Science degree from the University of Pittsburgh and holds undergraduate degrees from both Temple University (magna cum laude) and the Pennsylvania State University. She brought her skills from being a law firm librarian into the Information Security industry about two years ago. Tracy has presented at several Security BSides cons as well as at DEF CON's Recon Village in 2017. She is active online as your guide up a mountain of information on Twitter as

[@InfoSecSherpa](#)

### **Teens Just Wanna Have Fun**

*Melanie Warga, Assistant Director, Ohio County Public Library*

*Abigail Embry, Children & Teen Librarian, Ohio County Public Library*

### **Dogwood**

This will be a presentation on Teen programming in libraries; specifically dealing with the ways libraries can provide fun and exciting programs that speak to all types of teens without breaking the budget. Programs discussed will be cosplay events, up-cycled craft programs, decade parties, murder mystery events, retro movie marathons, fandom nights, glow-in-the-dark parties, chocolate Olympics, and urban survival, to name a few. The focus will be on how libraries can transform their space into an environment that not only welcomes all teens, but also engages them and makes them want to keep coming back.

### **Trauma Sensitive School Libraries**

*Melissa Gardner, School Librarian, Campbell County Middle School*

### **Walnut**

Research has shown that more than half of students enrolled in public schools have faced trauma or adverse childhood experiences (ACEs). One in six students struggle with complex trauma. For these students, fear often becomes a chronic condition which can manifest into struggles in academics, absenteeism, social challenges, and anxiety. The good news is that research also shows that students are resilient and that given the right environmental conditions and interventions, the symptoms associated with trauma may be reduced. School libraries are in a unique position in the school setting to provide many of these conditions. This session will provide information about research on ACEs and childhood trauma and ways the school library can be sensitive to the needs of these students.

### **One Library: Fellowship of the Book**

*Jim Peterson, IT Manager, Goodnight Memorial Library*

#### **Holly**

In the olden days, oral histories were the way knowledge and wisdom were passed on to future generations. Then came papyrus, vellum and parchment, and eventually, books. Not everyone could gain access to this knowledge, and things that shouldn't be forgotten, were. Surprisingly, this is still the case in many kingdoms, where Internet access and even parents' lives interfere with the education of some, bringing forth the need for improved access to all resources. For whatever reasons, some children cannot make the journey to the public library, and so begins this tale. Come hear how the Goodnight Memorial Library partnered with the Simpson County School Libraries to bring everything to all ...

### **Cultivating a New Image for the Curriculum Material Center**

*Jennifer S. Smith, Teacher Resource Center Librarian, Northern Kentucky University*

#### **Lily**

Curriculum material centers (CMC), or education material centers, or teacher resource centers often are mislabeled and misidentified. Because of the varied names they are known by and because of the preponderance of print, bulky, and unusual materials that often comprise their collections, CMCs are usually viewed as decorative flowers, and not the main crop. It's time to cultivate a new image! Plow through the long revitalization of one university's CMC as it grows its collection with online supplements. Watch as the purpose of the center unfolds in double blooms. Take home a few cuttings and graft them in to your CMC.

### **Social Dialogue and Your Collection: A Case Study**

*Sue Lynn McDaniel, Professor/Special Collections Librarian, Western Kentucky University*

*Delinda Buie, Curator, Rare Books, University of Louisville*

#### **Jasmine**

Over decades, nineteenth and early twentieth literature and cultural icons have faced challenge and occasional censure during shifts in society and politics. Delinda Buie, Rare Books Curator at University of Louisville, and Sue Lynn Stone McDaniel, Special Collections Librarian at Western Kentucky University have encountered mixed responses to their institutional collections related to the works of Kentucky writer Annie Fellows Johnston. They find that Johnston's 2018 induction into the Kentucky Writers Hall of Fame prompts fresh consideration of this often beloved but occasionally rebuffed writer. McDaniel's research on Annie Fellows Johnston provides a look at how librarians, educators, humanities organizations, and readers have evaluated the use of Johnston's *The Little Colonel* series during the past 25 years. Buie suggests that these stories for girls also may offer insight into broader cultural conversations, including current discussions regarding Confederate monuments. Together they offer ideas for providing archival resources to support dialogue.

### **FRIDAY, 11:00 - 11:50am**

#### **Open Educational Resources and Libraries: Current Trends and Future Directions**

*Sarah Hare, Scholarly Communication Librarian, Indiana University*

#### **Willow**

Current undergraduate students are estimated to pay over \$1,000 each academic year on their course materials, impacting students' ability to learn and engage with course content. This session will provide an introduction to one potential solution to this issue, Open Educational Resources (OER). In addition to discussing the benefits of OER and the barriers to widespread adoption, the session will provide an overview of the spectrum of ways that libraries are supporting OER creation and use. After providing some context, the session will outline important future directions for consideration, including pedagogy, government support, accessibility, and labor. These large themes will guide group discussion, which will provide a space for attendees to be able to learn more about areas of the open education movement that are of interest to them. ***Sponsored by the Academic Library Section***

As Scholarly Communication Librarian, **Sarah Hare** collaborates with subject librarians, the IU Press, and Library Technologies to educate and advise the campus community on open access and related issues. She also serves as liaison to IU's Office of Scholarly Publishing. Sarah's research focuses on scholarly communication outreach to undergraduate students and Open Educational Resources (OER). She frequently writes and presents on OER and open pedagogy, including "A critical take on OER practices: Interrogating commercialization, colonialism, and content" in *In the Library with the Lead Pipe*, an open access, open peer reviewed online journal. Sarah also teaches an eight-week Library Juice Academy course, "Introduction to Open Educational Resources," for library and information professionals worldwide.

Prior to joining the IU Libraries in 2017, Sarah served as Information Literacy Librarian at Davidson College, where she created open access programming and led two Open Educational Resource (OER) initiatives. She holds a Master of Science in Library & Information Science from the University of Illinois at Urbana-Champaign and a Bachelor of Arts in English from Wright State University in Dayton, Ohio.

### **We're Ready to Code, and You Can Be Too!**

*Susan Baier, Library Director, McCracken County Public Library*

*Lea Wentworth, Youth Services Librarian, McCracken County Public Library*

*Ann Schoenenberger, Digital Librarian, Kenton County Public Library*

#### **Lily**

McCracken County Public Library and Kenton County Public Library were among 28 libraries across the country selected to participate in the Ready to Code cohort. Learn about their adventures in teaching coding to youth in their communities, and how you too can start coding programs at your library even if you think Python is a snake! Come prepared for an interactive presentation, and as a bonus you'll leave with a kit to make an "unplugged" coding activity.

### **Eyes on the Digitized: Sharing Unique Content Through the Kentucky Digital Library**

*Ilona Burdette, Director, Kentucky Virtual Library*

*Nicole Frilling, Digital Branch Librarian, Kenton County Public Library*

*Edna Fugate, Archivist and Reference Librarian, University of Pikeville*

#### **Walnut**

Looking to share unique archival content beyond your library's four walls? Learn how to take advantage of KDL's low-cost, collaborative solution. Panelists will cover how to participate, technical requirements, available training, and more.

### **The Benefits of Beginning a Series Reading Program**

*Crystal Dougan, Library Media Specialist, Brickey-McCloud Elementary, Knox County (TN) Schools*

#### **Jasmine**

This past summer I ran across an Edutopia video that spoke to my heart as a librarian. It detailed the journey of a Las Vegas school that began a series reading program. The school made historic gains in reading growth and cultivated lifelong readers through its establishment. So, of course, I wanted to start the program at our school. I applied for a grant and received the funds to proceed. It is absolutely changing my students' lives and exceeding every expectation I ever had for it. I would love to share what we are doing with other librarians, so they can implement it as well and reap the rewards of the hard work.

### **How Well Were You Prepared? A Focus Group on the Education of School Librarians**

*Leslie Engelson, Metadata Librarian, Murray State University*

#### **Dogwood**

The universality of cataloging knowledge for all librarians has been recognized in theory but not demonstrated in practice in the curriculum of many LIS programs. In order to provide relevant instruction in programs for school librarians, educators must hear from practitioners about their needs. Because of the vast number of other responsibilities vying for school librarians' limited time, it is crucial for the educator to present instruction in cataloging that is highly relevant. Come to this session to learn about the cataloging instruction provided in the school library media program at Murray State University, as well as to voice your thoughts about how well your LIS program prepared you for the cataloging needs in your library, what you wished you had learned, and what continuing education needs you have. Be a part of impacting the education of future school librarians.

### **Skills Building with LearningExpress at KYVL**

*Enid Wohlstein, Senior Fellow, Kentucky Virtual Library*

#### **Holly**

Learn about career and job-hunting resources provide to Kentucky through KYVL. The session will cover what's in LEL career content and how to navigate through the interface. From ASVAB to Job & Career Accelerator, we'll cover quite a bit of what is on offer from LearningExpress.



### **FRIDAY, 12:00 – 2:00pm**

#### **KBA Luncheon Featuring Bethany Barton**

#### **Waterford Room (25<sup>th</sup> Floor)**

Our keynote speaker will be Bethany Barton, the KBA award-winning author of *I'm Trying to Love Spiders*. Be sure to purchase a ticket on the registration form.

**bethany bARTon** is an artist, author, and illustrator, based in Los Angeles. She is the author/illustrator of numerous children's books including *This Monster Needs a Haircut*, and *This Monster Cannot Wait*, both published by Dial/Penguin. Her 2016 book *I'm Trying to Love Spiders* was published by Penguin Random House, and has gone on to win numerous awards, including Children's Choice Awards 2016 Book of the Year. The follow up book *Give Bees A Chance* just hit book stores this spring. As a member of the motion picture union IATSE Local 44, Bethany spends her days working in art, prop & set decoration departments for film & TV, on shows like The Muppets, ABC's The Middle, The Mindy Project, FX's You're The Worst, and Amazon's The Last Tycoon. She is also an accomplished miniatures fabricator, and general maker-of-things. Bethany's art and writing capture the thoughts and feelings we all share: equal parts whimsy and reality; humor & heartbreak, whiskey & robots. Bethany makes art about being human and being honest. Her creations are an attempt to "say what everyone is thinking" - and in doing so help break down barriers... allowing people of every age to find commonalities; to connect; to identify with each other.

### **FRIDAY, 12:00 – 2:00pm**

#### **Complimentary Lunch in the Exhibit Hall**

#### **Archibald (3<sup>rd</sup> Floor)**

### **FRIDAY, 2:00 - 2:30pm**

#### **Book Signing in the Exhibit Hall**

Bethany Barton, Author

#### **Archibald (3<sup>rd</sup> Floor)**

**bethany bARTon** is an artist, author, and illustrator, based in Los Angeles. She is the author/illustrator of numerous children's books including *This Monster Needs a Haircut*, and *This Monster Cannot Wait*, both published by Dial/Penguin. Her 2016 book *I'm Trying to Love Spiders* was published by Penguin Random House, and has gone on to win numerous awards, including Children's Choice Awards 2016 Book of the Year. The follow up book *Give Bees A Chance* just hit book stores this spring.

### **FRIDAY, 2:00 - 2:50pm**

#### **Fake News--And Beyond**

*Tim Jones, Library Media Specialist, Trinity High School*

#### **Dogwood**

Americans recognize that fake news is a problematic issue by a 2-1 margin. Yet news consumers increasingly lack the basic media literacy skills to discern facts from falsehoods. In addition to overestimating their own media literacy skills, beliefs can also be rigid. Studies show that once a person believes an untruth, it can be very hard to persuade that person otherwise. Meanwhile, some methods of delivering fake news (e.g. memes, "deepfakes") pose special challenges. In such a climate where news literacy is declining, and news consumers are reluctant to consider information contrary to their held beliefs, how is a librarian to counter the rise of the fake news phenomenon?

This session attempts to tackle these and other essential questions, such as: What are the most important media literacy skills to emphasize? What makes good journalism? What is social media's role and what information do they collect about their users? What role in the local and national community can librarians play to increase media literacy skills? How important is prevention versus education? Why are most digital citizenship lessons inadequate in cracking filter bubbles?

## **BLURGH: Preventing Burnout & Compassion Fatigue**

*Julie Howe, Director of e-Learning and Health Sciences Librarian, SCC Learning Commons*

*Jessy Griffith, Teen Services Librarian, Kenton County Public Library*

### **Walnut**

It's hard to be a joyful librarian and work in a nation that doesn't always value your work. We must work hard for recognition AND somehow maintain the desire and passion that led us to this profession. This session will focus on how to advocate smarter, work harder, and care for yourself in kindness to be the librarian that you need to be in 2018 (and beyond).

## **The Challenge of Diversity in Kentucky Academic Libraries: We Talk the Talk, but Do We Walk the Walk?**

*Audrey Robinson-Nkongola, Assistant Professor/Campus Librarian, Western Kentucky University*

### **Jasmine**

Inclusion and diversity seem to be difficult for Kentucky libraries to obtain. During this session, diversity in Kentucky academic libraries will be examined, as well as how it can be obtained and sustained. It is not enough to simply hire someone who is not of the dominant culture; retention is paramount.

## **Preserving Digital Collections**

*Danielle Spalenka, Preservation Specialist, NEDCC*

### **Lily**

Are you preserving your digital collections and ensuring that they will survive for future generations to access? Your organization may have recordings of oral histories, digital or digitized photographs and documents, reformatted video files, and other materials in digital form. You can determine your next steps toward preserving these materials by learning about ways to assess digital preservation. In this session you will gain an understanding of the challenges of digital preservation and the ways that assessment can make those challenges more manageable, and you will be introduced to newly-released, free resources for assessing digital preservation of your collections. The information presented in this session will be useful for libraries of all sizes that are looking for resources for preserving unique digital collections.

## **Virtual READality**

*Sam Northern, Teacher-Librarian, Simpson Elementary School*

### **Holly**

Libraries have long served as points for users' first exposure to new technologies. We can again play that role with virtual reality (VR). VR enables experiential learning by simulating real-world environments. Virtual reality is more than seeing places in 360 degrees. It is becoming an important tool for users to connect with and experience cultural events, institutions, and collections. These connections advance users' multiple literacy skills. This session discusses how libraries can use VR to enrich information services and promote the love of reading. Participants will have the opportunity to try out VR equipment and programs for themselves. This first-hand experience will reveal how VR has the potential to promote many forms of literacy.

## **FRIDAY, 3:00 - 3:50pm**

### **Behind Closed Doors--Behind the Scenes Look into the Newbery Award**

*Lori Hancock, School Librarian, The Lexington School*

### **Willow**

Join 2018 Newbery Committee member, Lori Hancock, as she gives a behind the scenes look at serving on the most prestigious book award committee.

## **Music from Cradle to Grave**

*Stacy Tiller, Children's and Teen Librarian, Spencer County Public Library*

*Laura Mann, Librarian, Spencer County Public Library*

### **Jasmine**

Spencer County Public Library offers several programs that focus on music for infants through senior adults. Stacy and Laura will share these programs and discuss how they got started, hardships, successes, and community partners that made some of them possible.

## **Getting Published in IN-FO-CUS and Kentucky Libraries**

*Erin Gow, Online Services Librarian, University of Louisville Law Library*

*Robin Harris, Public Services Librarian, University of Louisville Law Library*

### **Walnut**

Have you ever wondered how authors get published in Kentucky Libraries and IN-FO-CUS, our two Kentucky Library Association publications? Is Kentucky Libraries peer-reviewed? Can an author submit the same article to Kentucky Libraries and another publication? How does Kentucky Libraries differ from IN-FO-CUS? How does an author decide whether to submit to Kentucky Libraries or IN-FO-CUS? The editors of IN-FO-CUS and Kentucky Libraries will answer these questions and discuss publication guidelines, types of articles accepted, the editing process for each, and the benefits of publishing in each. The presentation will include online examples of articles and graphics from each publication, along with a handout for participants. Presenters will leave time for questions at the end of the session. Recommended for potential authors from all types of libraries.

## **DNA and the Construct of Identity: Assisting Genealogy Patrons with DNA Questions**

*Cheri Daniels, Head of Reference Services, Kentucky Historical Society*

### **Dogwood**

The DNA field in relation to genealogy is changing at a rapid pace, and continues to challenge our understanding of family, race, community, and history. As DNA testing grows ever more popular, our programming and reference services must be ready to address the difficult questions that accompany this genealogy-related activity. Sadly, many of those opting to test may have limited research skills, if any. Despite the emotional reactions and challenges to ancestral identity that may accompany the results, library staff need to be prepared to guide patrons to the resources and tools necessary to help them understand the broader subject—and how this interpretation is forever tied to the research process. No longer can we teach genealogy literacy skills without incorporating the tools necessary to understand DNA results.

## **Guardians of the Library: When Disaster Strikes**

*Melissa Gardner, School Librarian, Campbell County Middle School*

### **Holly**

Do you know what to do if your library is affected by a disaster such as fire or flood? How would you begin the clean-up process and the process of replacing lost or damaged materials? This session will provide resources to prepare you for what you can do, as well as tips from experienced school librarians who have faced disasters in their library.

## **Lies, Constructed and Contextual Lies, and Statistics: Narrative Evaluation and Statistical Literacy in the Interdisciplinary Honors Classroom**

*Dr. Lisa W. Kay, Professor, Dept. of Mathematics & Statistics, Eastern Kentucky University*

*Trenia Napier, Reference and Instruction Librarian, and Associate Director, Programs and Outreach of the Noel Studio, Eastern Kentucky University*

*Dr. Kevin L. Jones, Reference and Instruction Librarian, Eastern Kentucky University*

### **Lily**

Literature and statistics tell similar stories in different ways, but what happens when narratives and numbers are manipulated? Furthermore, what happens when fiction, fact, and personal experience are in conflict? Given the growing access to numerical data and instances of data manipulation in the media, statistical literacy is a critical, lifelong skill, and interdisciplinary courses are uniquely positioned to engage students in interpreting the world around them. Unfortunately, while those who teach statistics encourage students to locate and use statistical sources as evidence, faculty outside of statistics seldom discuss how to read, interpret, and evaluate quantitative information. In light of the ACRL's Framework for Information Literacy in Higher Education approach to authority as "constructed and contextual," faculty from statistics, the writing center, and the library will present effective ways to incorporate statistical literacy into existing information evaluation approaches to break down confirmation bias and preconceived notions, while improving interdisciplinary instruction.

## **FRIDAY, 4:00 – 4:50pm**

### **Piecing Together the Past and Uncovering the Future Through Hands-On History**

*Jennifer Disponette, Student Engagement Coordinator, The Kentucky Historical Society*

### **Lily**

Whether it be Artifact Analysis, Inventions, or American Indian Pinch Pots, the Kentucky Historical Society has a suite of programming perfect for bringing together students, parents, and communities. Join us as we delve into the outreach programming available to libraries and the techniques used by the Historical Society's educators to engage audiences of all ages and backgrounds in artifact and primary source exploration.

### **Librarians Cultivating Lifelong Learning**

*Dr. Sandra L. McGuire, Professor Emeritus, University of Tennessee*

#### **Jasmine**

Worldwide people are living longer than ever before. A child today can expect to live to be 80, 90, or 100 years old. People need to be prepared for the long life ahead of them. Librarians have a unique opportunity to promote lifespan learning and lay a foundation for positive aging with children. Readily available resources for children's literature with meaningful portrayals of age and aging, including the A is for Aging, B is for Books blog, the Growing Up and Growing Older: Books for Young Readers booklist, and the Association for Gerontology in Higher Education award for Best Children's Literature on Aging will be presented. Librarians have the opportunity to support activities that promote lifespan learning, promote positive aging, and increase intergenerational understanding. Intergenerational library activities including celebrations of Older Americans Month and Intergeneration Month will be presented.

### **Building a Better Bookmark—a 3D Printing Project**

*Adele Koch, Librarian, Sacred Heart Model School*

#### **Walnut**

My 4th and 5th grade students have been using some time in the library to investigate, design, create, and evaluate bookmarks using a variety of materials including our school's 3D printer. This session will go through the design process and discuss the logistics of using the 3D printer with a class.

### **KYVL and Your Community: Career, Consumer Health, and Business Resources**

*Enid Wohlstein, Senior Fellow, Kentucky Virtual Library*

#### **Dogwood**

The session will cover general usage of KYVL health, career, and business resources but also gets into details on navigation, advanced features, and content. There will be something for everyone, from those who are novice users to those who have more experience.

### **Kickstart Your Connections: How to Elicit Action and More Conversation in Just a Few Words**

*Janette B. Carver, Chemistry, Physics & Astronomy Liaison, University of Kentucky Libraries*

*Debbie Sharp, Director of Information Literacy, University of Kentucky Libraries*

#### **Holly**

When was the last time you found yourself with an opportunity to share the successes and challenges of your library with a potential benefactor or collaborator? Are you prepared to tell your story in 2 minutes or less? In business circles it's called an "elevator speech," but it's actually more of an introduction intended to pique someone's interest to learn more. This presentation provides a background and structure that will enable you to walk away with a plan for telling your story and making connections. Participants will learn how to utilize a few planning steps to prepare concise speeches for a variety of occasions.

### **What's New in YA Literature**

*Terri Grief, Speaker, Bureau of Research & Education*

#### **Willow**

Terri will brief you on the newest books published in 2018 for grades 6-12.

**5:30 – 6:30pm**

**KASL Board Meeting**

**Walnut**

**Saturday, September 22, 2018**

**7:00 – 8:00am**



## **New for Saturday Attendees -Breakfast with the Exhibitors**

### **Archibald (3<sup>rd</sup> Floor)**

**8:00 – 8:50am**

#### **Let's Connect: With K-5 KBA Books 18-19**

*Linda Ann Wrins-Ryan, Library Media Specialist and K-2 KBA Committee Member, Lowe Elementary*

#### **Dogwood**

Do you want to implement a KBA program in your school but don't know where to start? Or are you looking for fresh ideas? Gain an overview of the newest elementary KBA titles and how you can connect students to them in your library. Lesson ideas and tips will be included. I will also share how to start a dynamic 21st Century book club and begin a collaborative library lesson share program with librarians in your district. Bring your digital device!

#### **How, When, & Why eBooks Are Culturally Relevant & Support Culturally Responsive Teaching Across Curriculum**

*Jamey Herdelin, Library Media Specialist, JCPS*

#### **Holly**

eBooks support culturally responsive teaching by providing students access to and engagement with a wide range of resources, while activating different learning styles. eBooks and their interactive tools and features can motivate students to engage with the text, resulting in literacy growth and development. One challenge facing schools and librarians is that research shows that educators do not engage with technology like eBooks if they do not have the self-efficacy to do so nor see their value. Another is that many schools and districts do not have a plan, a framework for selecting eBooks to support student engagement in the learning environment. This presentation's goal is to help educators develop the self-efficacy needed to engage with eBook interactive tools and features, and see the value in doing so AND begin the collaboration between library media specialists and classroom teachers to select and integrate eBooks within the learning environment.

#### **High School KBA Nominees**

*Amanda Hurley, Library Media Specialist, Henry Clay High School*

#### **Willow**

Members of the Kentucky Bluegrass Awards selection committee and readers will present which next titles are on the list of the best books for young adult readers (grades 9-12).

**9:00 – 9:50am**

#### **Reading Research for Leaders**

*Shannon Bosley, Library Media Specialist, Dixie Heights High School*

#### **Holly**

What does the research say about being an active reader in a leadership position? What is the importance of being an active reader as an adult in an educational setting? Let's look at what the research tells about being an effective leader in relationship to being an active reader. We'll discuss how you can take this information and promote more active reading for the adults in your school.

#### **2018-2019 KBA Master List for Middle School**

*Emily Northcutt, School Librarian/Technology Coordinator, Hearn Elementary School*

*Deena Martin, 7th Grade ELA, Jessie Clark Middle School*

*Lori Hancock, School Librarian, The Lexington School*

*Renee Hale, Library Media Specialist, Drakes Creek Middle School*

#### **Dogwood**

Join us to hear about this year's 2018-2019 Kentucky Bluegrass Award Master List titles for Grades 6-8! Come listen to book talks, watch trailers, and get access to materials and ideas for promoting the KBA program in your school.

## **Free Little Libraries**

*Amanda Hurley, Library Media Specialist, Henry Clay High School*

### **Willow**

Build a community of readers -- literally! Come to this session to learn about Little Free Libraries. Ideas will be shared on how to buy or build a Little Free Library, how to stock them, and how to maintain stewardship over them. It's a great project for any library!

## **SATURDAY, 10:00 – 10:50am**

### **What's New? What's You 2018**

*Janet Lanham, Resource Librarian, Jefferson County Public Schools, Library Media Services Dept.*

*Karen Pruitt, Cataloger, Jefferson County Public Schools, Library Media Services Dept.*

### **Dogwood**

Don't miss your annual update on school libraries, education, tech, and a grab bag of whodathunkits! This fast-paced overview covers trends, research, and the latest buzz—you won't want to be left out of the loop! We're looking forward to seeing familiar faces and newcomers for the 2018 version. See you soon!

## **KYVL for K12**

*Enid Wohlstein, Senior Fellow, Kentucky Virtual Library*

### **Holly**

Come learn about Britannica, Explora, Scholastic GO!, and Learning Express from KYVL. The session will cover general usage but also gets into details on navigation, advanced features and content. There will be something for everyone, from those who are novice users to those who have more experience.

## **The Ambassadors of Empathy (aka School Librarians)**

*Bethany Barton, Author*

### **Willow**

A special presentation from the KBA guest author.

## **SATURDAY, 11:00 – 11:50am**

### **Ten Minute Tech Tips**

*Renee Hale, Library Media Specialist, Drakes Creek Middle School*

### **Dogwood**

Need a quick professional development idea? What about 10-minute tech tips? I will share quick PD offerings that can be taught in 10 minutes or less. Tech tips include Google Keep, KYVL, Canva, and Symbaloo.

## **Beyond Cute: KBA Preschool Books 18-19**

*Becky B. Nelson, Adjunct Faculty, University of Kentucky*

### **Willow**

The new list is out! Hear about the 10 books on the list for our very youngest readers, why they are special, why they were chosen. The session includes tips on how to use these books with children and voting ideas.

## **Breakout in the Library**

*Brigette Thompson, Library Media Specialist, McCracken County High School*

*Leslie Wright, Library Media Specialist, McCracken County High School*

### **Holly**

Breakout EDU is a classroom activity based on the idea of popular "Escape Rooms." Students are given a scenario and then use hints and clues to figure out various combinations for locks on the Breakout box. While an Escape Room is an effort to get out of the room, Breakout EDU is trying to get into the box. This session will show how we have incorporated two Breakout EDU kits into the library. It will include playing a Breakout game and examples of games we have used/created in various

content areas like U.S. History, Early Childcare, and English. We have also set up competitions for both student and teacher teams.

### **SATURDAY, 12:00 – 12:50pm**

#### **Great Apps in iOS 10 or 11**

*Adele Koch, Librarian, Sacred Heart Model School*

#### **Willow**

Did your iPad update and now your favorite apps don't work anymore? Come hear about some great apps (new and favorites) that work in iOS.

#### **Let This "Dynamic Duo" Answer Your Graphic Novel Questions!**

*Tim Jones, Library Media Specialist, Trinity High School*

*Mitch Greenwell, English Teacher/Literacy Coach, Trinity High School*

#### **Dogwood**

Graphic novels aren't just about superheroes. They include memoirs, non-fiction, minority voices, manga, and many other rich genres. A dynamic duo of a library media specialist and an English teacher of a graphic novel course are here to answer your questions. This presentation explores: What makes a quality graphic novel? What makes the genre of comics its own unique art form? Can graphic novels make you smarter? How do graphic novels use panels, bleeds, perspective, realism, negative space, and texture to help tell a story? How can you use graphic novels to teach students the art of storytelling? What is the graphic novel's cultural influence? Are they appropriate for independent reading? For ESL? What are some successful cross-promotional strategies for your collection? With a heavy emphasis on teens, this presentation also explores: How can you build a graphic novel collection with strong cross-curricular connections (including hot titles and core titles)?

#### **Millionaire Readers Club**

*Heather Kirkman, Librarian, Alex R. Kennedy Elementary*

#### **Holly**

Ready for a low-cost reading incentive program at your school? Find out how you can implement the Millionaire Reader's Club in your elementary. Students will be proud that they read one million words. You can save time collecting reading logs by using Google forms.

### **SATURDAY, 1:00 – 1:30pm**

#### **KASL Business Meeting**

*Professional Development Certificates distributed at program conclusion.*

#### **Willow**

**Thank you to our Meeting Sponsors!**

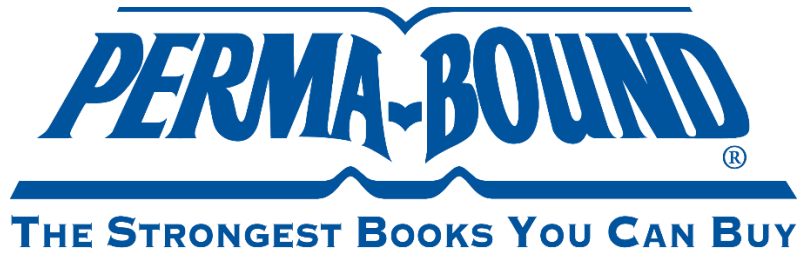

## Map of 2<sup>nd</sup> Floor of Galt House Rivue Tower

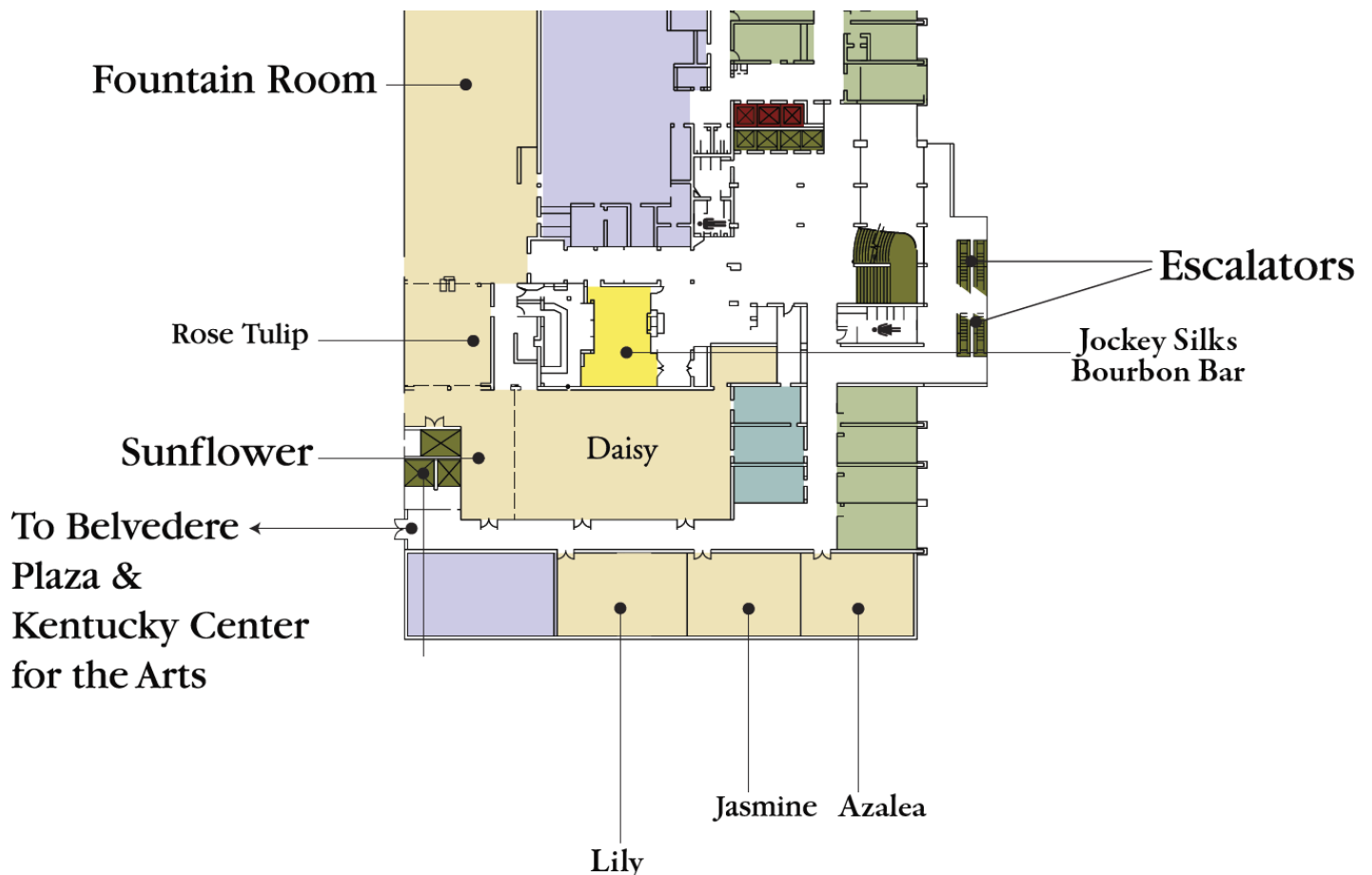

## Map of 3rd Floor of Galt House Rivue Tower



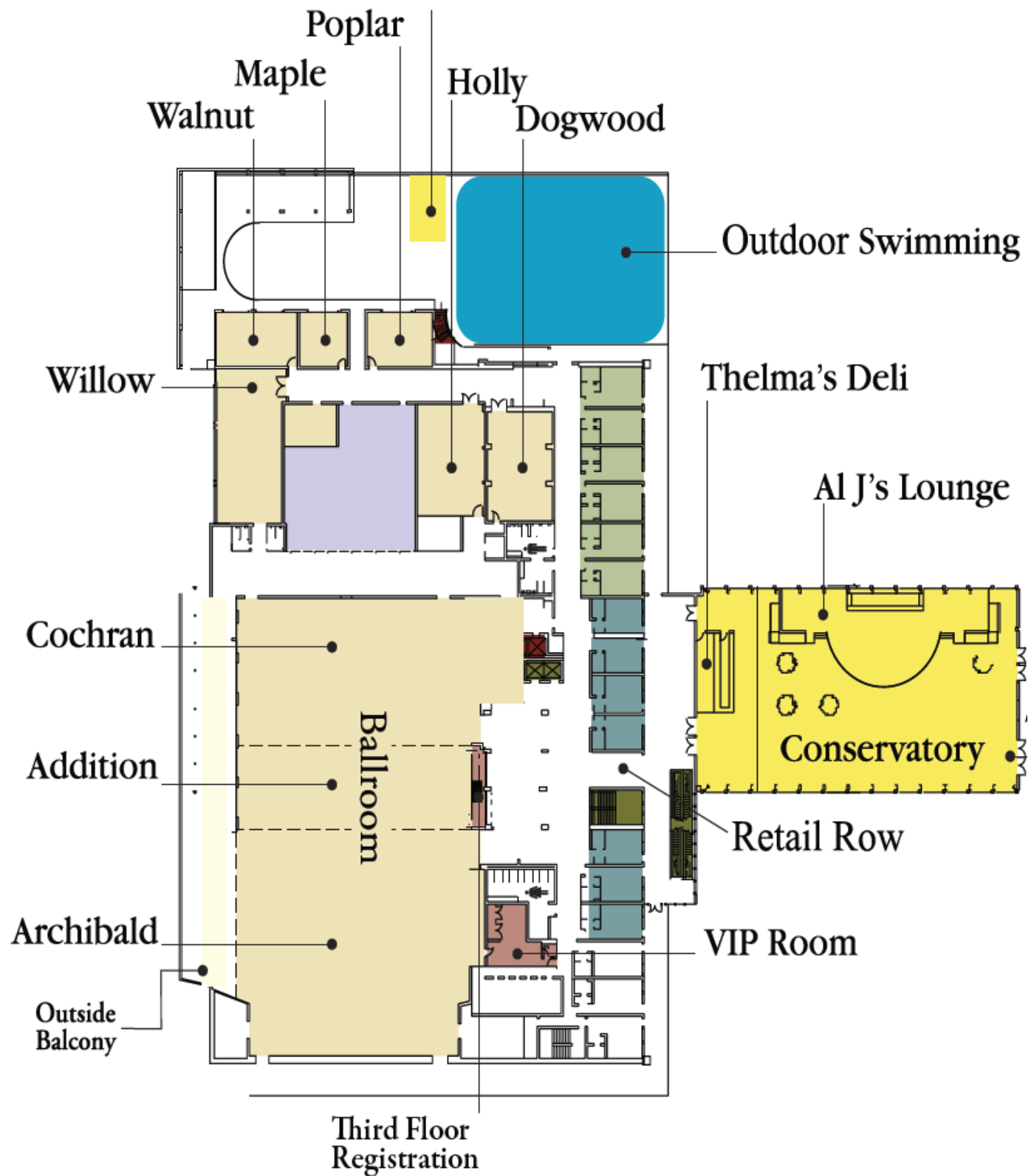

# KLA/KASL Joint Annual Conference

## Sept 20-22, 2018 \* Galt House Hotel \* Louisville, KY

*Please Print*

Full Name \_\_\_\_\_ Email \_\_\_\_\_

Mailing Address \_\_\_\_\_ Phone \_\_\_\_\_

City \_\_\_\_\_ State \_\_\_\_\_ Zip \_\_\_\_\_

Library \_\_\_\_\_ Library City \_\_\_\_\_

Type of Library ☐ Academic (*postsecondary*) ☐ Public ☐ School (*K-12*) ☐ Special (*law, medical, etc*)

**CIRCLE the fees for events you will attend. *ALL registrants MUST pay a meeting registration fee.***

MEETING REGISTRATION FEES	KLA MEMBERS <i>After 9/7</i>	NON-MEMBERS <i>After 9/7</i>	SUBTOTALS
Full Conference	\$145	\$215	
Student	\$15	\$30	
Retiree	\$30	\$50	
Thursday ONLY	\$120	\$180	
Friday ONLY	\$120	\$180	
Saturday ONLY	\$120	\$180	

OPTIONAL EVENT FEES		
Thursday KLA Awards Luncheon, featuring Silas House, author	\$40	
Thursday Evening Scavenger Hunt <i>Circle 'Free' if you plan to participate.</i>	Free	
Friday KBA Luncheon, featuring Bethany Barton, author	\$37	

☐ This is my first KLA meeting.

☐ Please contact me about my special physical/dietary needs.

**TOTAL \$ \_\_\_\_\_**

☐ Charge my Visa MC Discover AmEx ☐ Check Enclosed (payable to KLA) ☐ PO Enclosed

Name on card \_\_\_\_\_ Email \_\_\_\_\_

Full Billing Address \_\_\_\_\_

Card Number \_\_\_\_\_ Exp \_\_\_\_\_ Sec. Code \_\_\_\_\_

Signed \_\_\_\_\_ Date \_\_\_\_\_

***Return this form with payment or Purchase Order to the KLA  
Conference Registration Desk on the 3rd Floor.***